

Please make sure to read the enclosed Ninja® Owner's Guide prior to using your unit.

NINJA

Auto-iQ
ONE-TOUCH INTELLIGENCE

COMPACT BLENDER DUO QUICK ASSEMBLY

NUTRI NINJA® CUPS



1. Connect Nutri Ninja base to power.

NOTE: Lights will NOT illuminate until the cup is engaged on base and the POWER button has been pressed.



2. Fill the cup with desired contents and screw on blade assembly clockwise until you have a tight seal.

3. Turn the cup upside down and lower it onto the base.



4. Turn the cup clockwise to lock into place.

NOTE: Once cup is correctly locked onto base and power button has been pressed, program buttons will illuminate and the Nutri Ninja is ready for use.

⚠ WARNING: Handle the Pro Extractor Blades Assembly with care, as the blades are sharp.

BLENDER PITCHER



1. Connect Nutri Ninja base to power.

NOTE: Lights will NOT illuminate until the cup is engaged on base and the POWER button has been pressed.

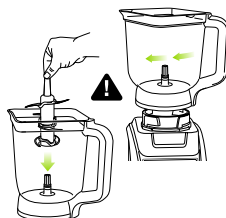

2. Holding the stacked blade assembly by the top of the shaft, insert it into the pitcher.

3. Fill pitcher with desired contents, then place on base and turn clockwise to lock in place.



3. Align the arrows on the lid and handle, then lower handle to lock in place.

NOTE: Once pitcher is correctly locked onto base and POWER button has been pressed, program buttons will illuminate and the Nutri Ninja is ready for use.

BLEND & PREP BOWL



1. Connect Nutri Ninja base to power.

NOTE: Lights will NOT illuminate until the cup is engaged on base and the POWER button has been pressed.

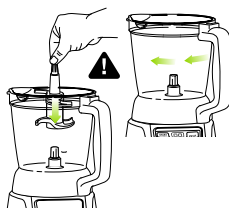

2. Holding the desired blade assembly by the top of the shaft, insert it into the bowl.

3. Fill bowl with desired contents, then place on base and turn clockwise to lock in place.



3. Align the arrows on the lid and handle, then lower handle to lock in place.

NOTE: Once bowl is correctly locked onto base and POWER button has been pressed, program buttons will illuminate and the Nutri Ninja is ready for use.

⚠ WARNING: Blade Assemblies are sharp and not locked in place. Make sure lid is locked onto the bowl before pouring. If pouring without lid, carefully remove Blade Assembly first. Failure to do so will result in a risk of laceration. Refer to the Ninja Owner's Guide for additional information.

QUESTIONS? We're here to help. Visit us at www.ninjakitchen.eu

Please make sure to read the enclosed Ninja® Owner's Guide prior to using your unit.

NINJA®



COMPACT BLENDER DUO QUICK ASSEMBLY

Thanks to smart settings with unique variable blending patterns, you can expect smooth, consistent, professional-quality results every time—no guesswork required.



AUTO-IQ® SMOOTH BOOST™

The Auto-iQ Smooth Boost button controls the level of smoothness for all types of drinks.

EXTRACT

For deliciously drinkable nutrient juices*, ensure **SMOOTH BOOST "YES"** is selected, then press **EXTRACT**.

BLEND

To whip up perfect, smooth drinks and smoothies, ensure **SMOOTH BOOST "YES"** is selected, then press **BLEND**.

TIP

If you'd like your drink to have more texture and fullness, press **SMOOTH BOOST "NO"**.

*Extract a nutritious drink containing vitamins and nutrients from fruits and vegetables.



AUTO-IQ EXTRACT

- **Great for:** Leafy greens, fibrous fruits and vegetables, seeds, and ice.
- Auto-iQ Nutrient Extraction* is specially designed to work only with your Nutri Ninja Cups.

*Extract a nutritious drink containing vitamins and nutrients from fruits and vegetables.



AUTO-IQ BLEND

- **Great for:** Milkshakes, frozen drinks, smoothies, and sauces.
- Use the Auto-iQ Blend setting with your Blender Pitcher or Nutri Ninja cup.

CLEANING

WARNING: Handle the Blades Assemblies with care when washing, as the blades are sharp. Contact with the blades' edges can result in laceration.

Hand washing: Wash containers, lids and Blades Assemblies in warm, soapy water. When washing Blades Assemblies, use a dishwashing utensil with a handle to avoid direct hand contact with blades. Handle the Blade Assembly with care to avoid contact with sharp edges. Rinse and air-dry thoroughly.

Dishwasher: The Containers, lids and Blades Assemblies are all dishwasher safe. The lids and Blades Assemblies are top-rack dishwasher safe. Ensure the Blades Assemblies is removed from the container before placing in the dishwasher.

QUESTIONS? We're here to help. Visit us at www.ninjakitchen.eu